



AUTOMOTIVE CORPORATION

STEERABLE DRIVE AXLE SPECIFICATIONS FABCO MODEL SDA-2100

The Fabco Model SDA-2100 Steerable Drive Axle is an exposed Cardan joint design, developed for use on-highway with rough terrain capability.

Maximum Capacity	21,000 Pounds Load Rating
Brakes	
Type	Drum, S-cam
Size	16.5 Diameter x 7 Inch
Chamber	30 Square Inch
Certification	FMVSS 121
Slack Adjusters	Automatic
Housing	Fabricated Steel, Cast Banjo, Center Bowl
Camber	1/2 Degrees Positive
Wheels	
Mounting	10-Studs on 11.25 Inch Bolt Circle
Minimum Wheel Size	20 Inch
Differential Carrier	Spiral Bevel
Ring Gear Diameter	16.5 Inch
Pinion Spline	2.00 Inch Diameter, 39 Spline Involute
Single Reduction Ratios	4.11, 4.33, 4.56, 4.88, 5.29, 5.57, 6.14
Universal Joint	Single Cardan, 9C
Steering	Ackerman to Match Wheelbases 160" to 185" or 186" to 219" Dual Steering Arms
Kingpins	
Type	Spherical, Nylatron Races
Inclination	5 Degrees
Track	91.75 Inches across Wheel Mounting Faces
Axle Shafts	
Spline	2.100 Inch Diameter, 41 Spline Involute
Body	1.95 Inch Diameter
Turn Angle	35 Degrees
Lubrication	
Type	SAE 90, 140, 80W-140
Capacity	15 Quarts (Est.)
Weight – Dry	1,925 Lb.

OPTIONS: 10-Studs on 13 3/16 Inch, 285.75mm or 335mm B.C.
Double Reduction Ratios: 5.31, 5.61, 5.91, 6.21, 6.65, 7.21, 7.60, 8.38, 8.96, 9.77
axle tracks

For parts or service call us
Pro Gear & Transmission, Inc.



1 (877) 776-4600

(407) 872-1901

parts@eprogear.com

906 W. Gore St.

Orlando, FL 32805



REFERENCE INFORMATION
 21000 POUNDS LOAD RATING,
 16.3" x 7.0" S-CAM BRAKES,
 13.0" LUBE CAPACITY
 DRY WEIGHT 1923 LB.

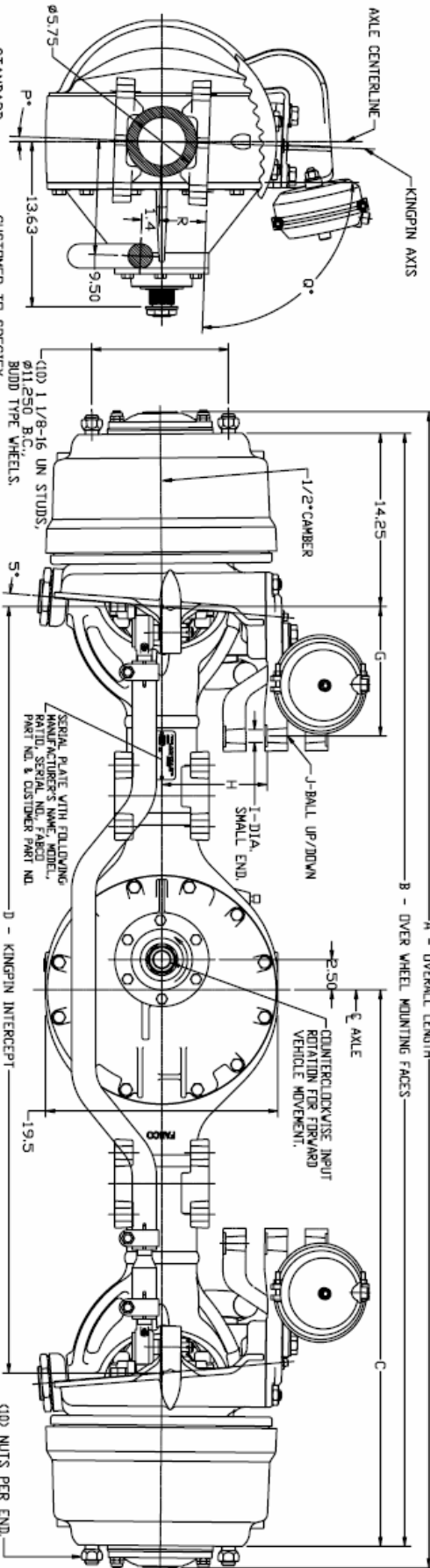
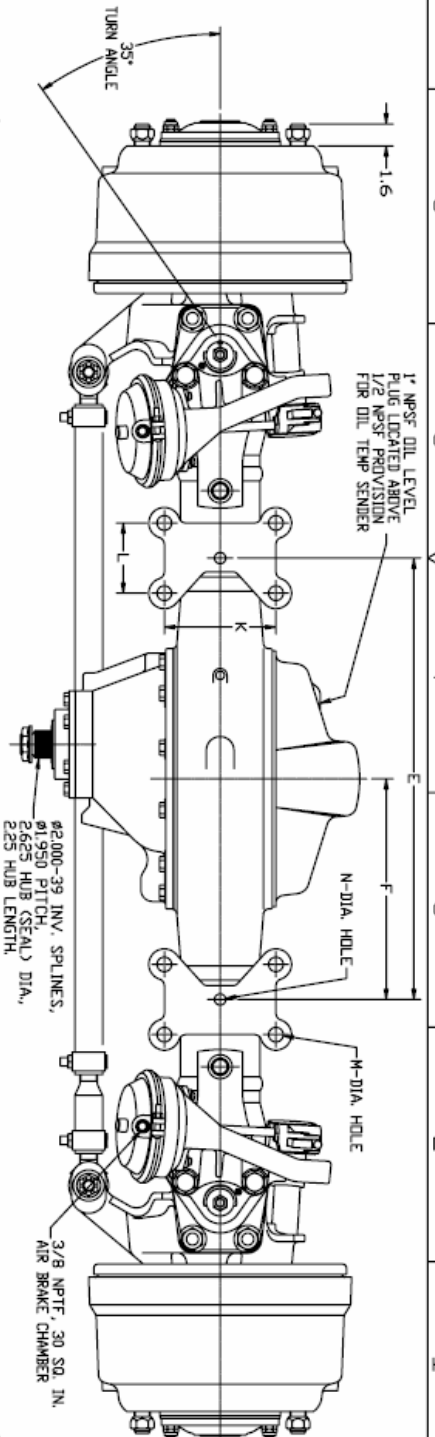

A	B	C	D	E	F	G	H	I	J	K	L	M	N	P	Q	R
96.0	91.8	45.9	63.3													
CUSTOMER PART NO.										FABCO PART NO.						
RATIO										AVAILABLE OPTIONS:						

AVAILABLE OPTIONS:
 DUAL STEERING ARMS,
 DOUBLE REDUCTION DIFFERENTIAL,
 HIGH ENTRY DIFFERENTIAL,
 CONTROLLED TRACTION DIFFERENTIAL,
 STUD PILEDED 13188 B.C. HUBS,
 HUB PILEDED 285.75mm DR 335mm B.C.
 ABS PROVISION
 STEERING ACKERMAN TO MATCH WHEELBASE
 CENTRAL TIRE INFLATION (SEE 555 154)

NOTE: ALL DIMENSIONS ARE REFERENCE.
 SINGLE REDUCTION RATIO: 4.11, 4.33, 4.56, 4.88, 5.29, 5.57, 5.86, 6.14,
 DOUBLE REDUCTION RATIO: 5.31, 5.61, 5.91, 6.21, 6.65, 7.21, 7.60, 8.38, 8.96, 9.77

THE INFORMATION CONTAINED HEREIN IS THE PROPERTY OF FABCO. IT IS TO BE USED ONLY FOR THE PURPOSES SPECIFIED AND IS NOT TO BE REPRODUCED OR TRANSMITTED IN ANY FORM OR BY ANY MEANS, ELECTRONIC OR MECHANICAL, INCLUDING PHOTOCOPYING, RECORDING, OR BY ANY INFORMATION STORAGE AND RETRIEVAL SYSTEM.		ALL TRADE DIMENSIONS ARE IN MILLIMETERS UNLESS OTHERWISE SPECIFIED.	
FABCO ENGINEERING DIVISION 1000 W. 10TH AVENUE DENVER, CO 80202 PHONE: 303.733.7777 FAX: 303.733.7778 WWW.FABCO.COM		FABCO ENGINEERING DIVISION 1000 W. 10TH AVENUE DENVER, CO 80202 PHONE: 303.733.7777 FAX: 303.733.7778 WWW.FABCO.COM	
AXLE STEERABLE DRIVE, MODEL SDA-2100		555 151E1	